

Working with N-Sensor and Agricon CCI 1200

Software on the CCI-Terminal at least 2.0.0

Cabling guide CCI 1200 - agriBox

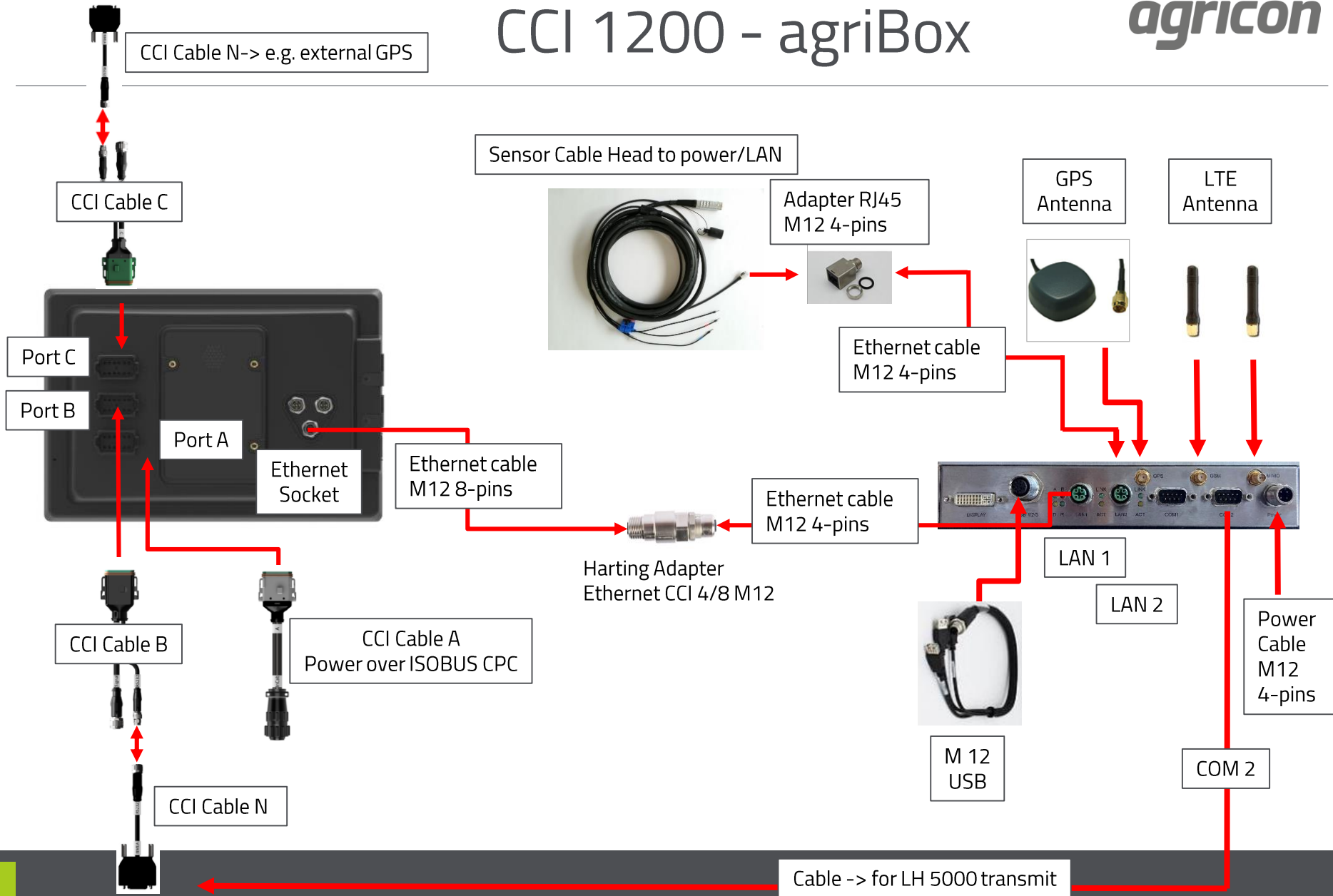

Terminals – ISOBUS CCI 1200

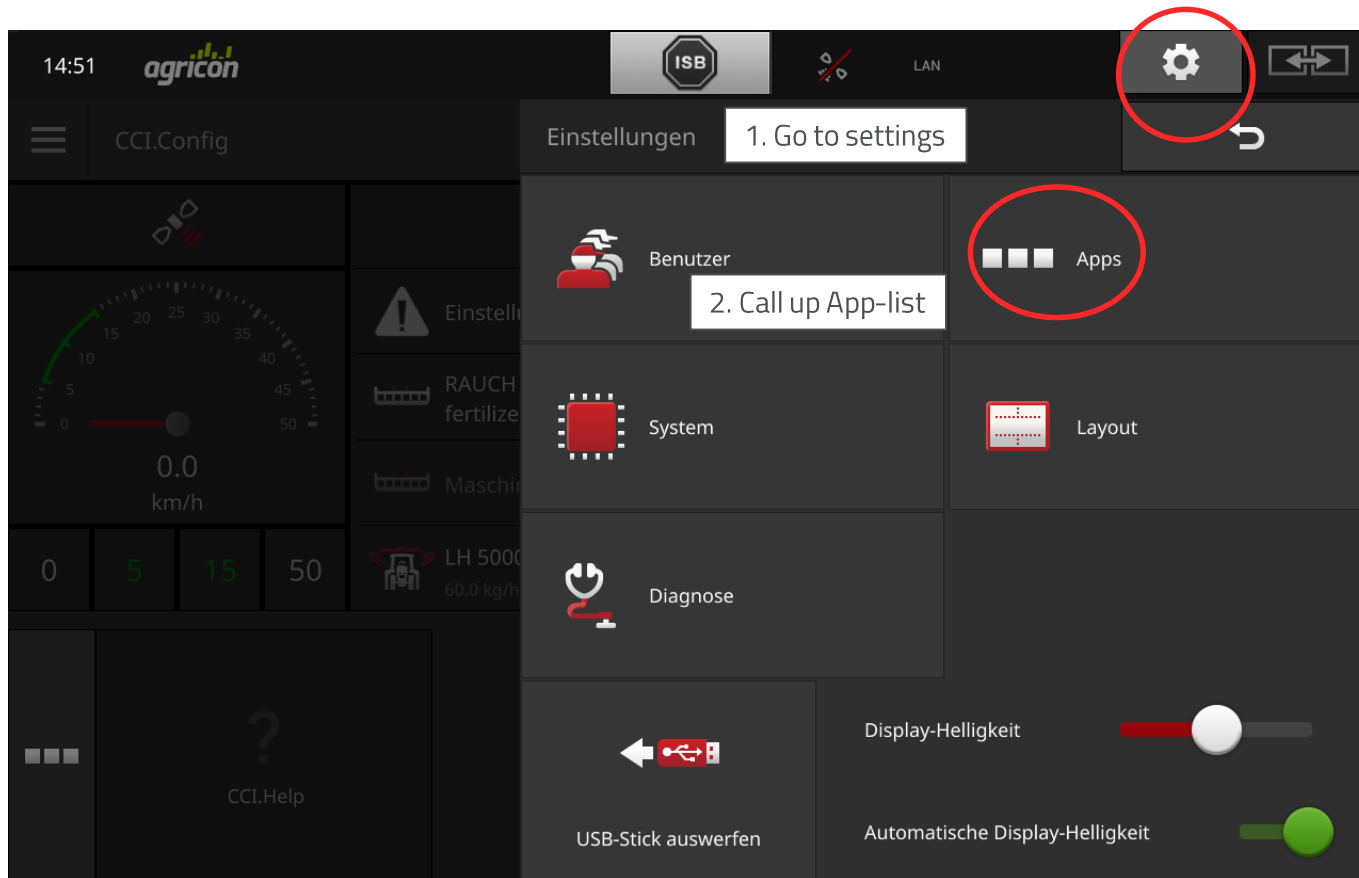

Terminals – ISOBUS CCI 1200

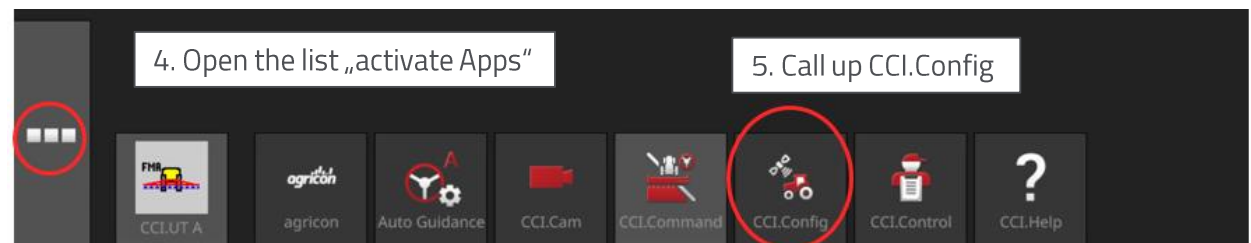
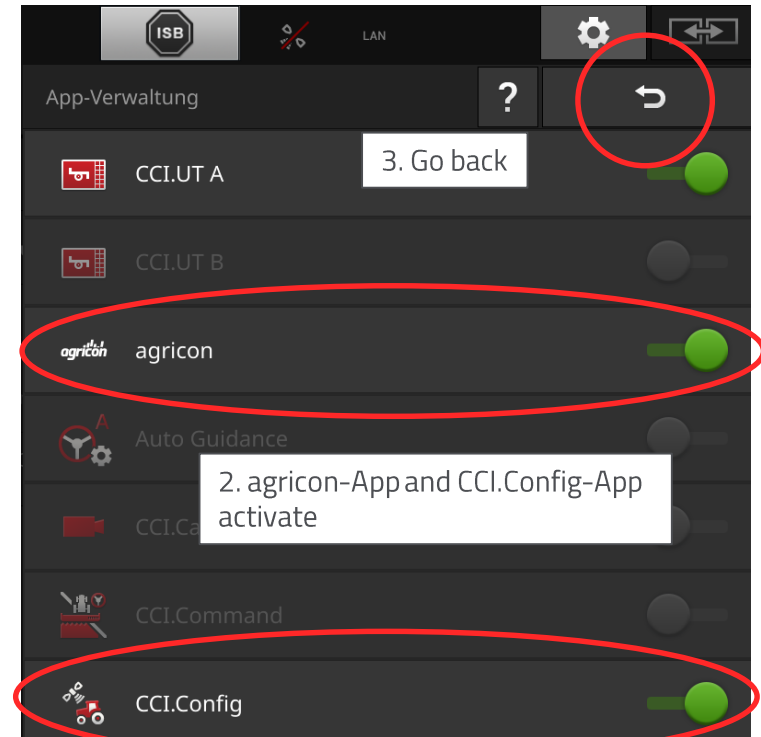
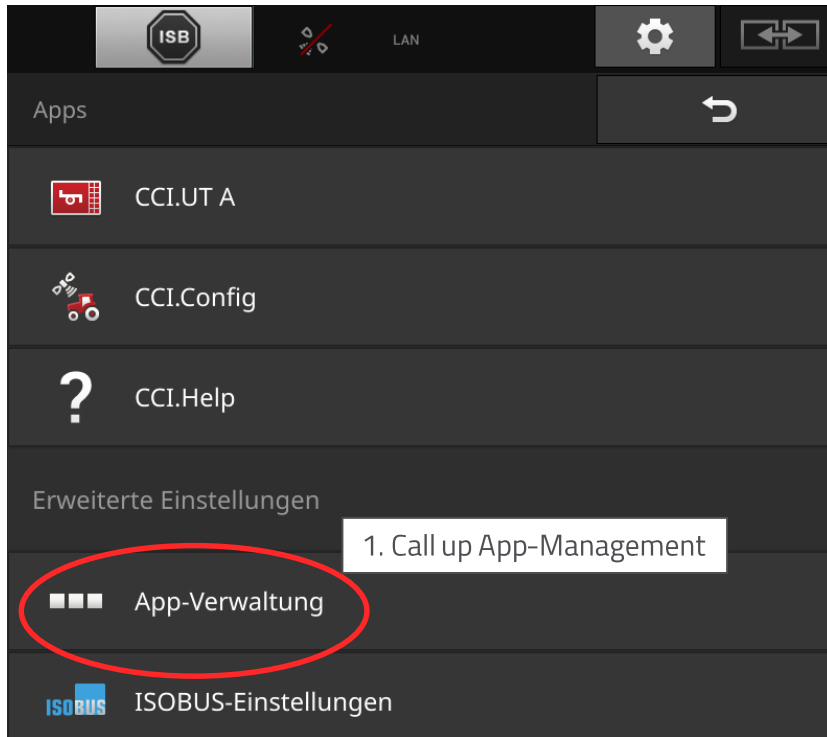

Terminals – ISOBUS CCI 1200

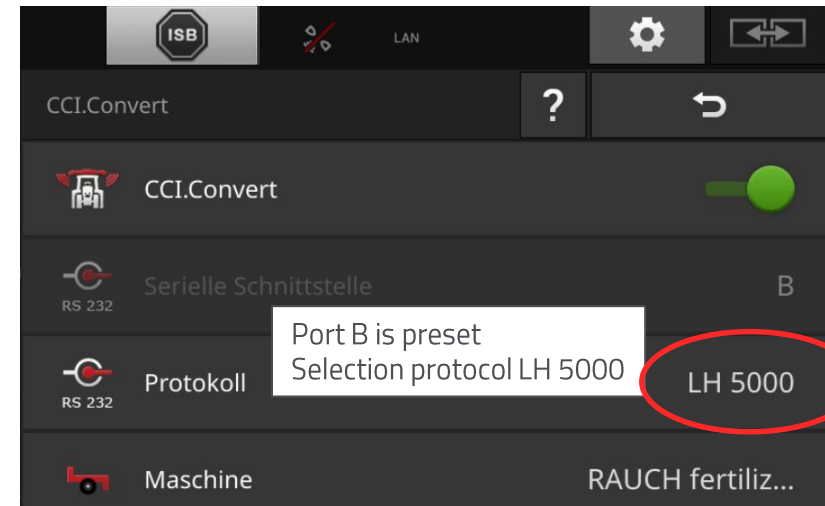
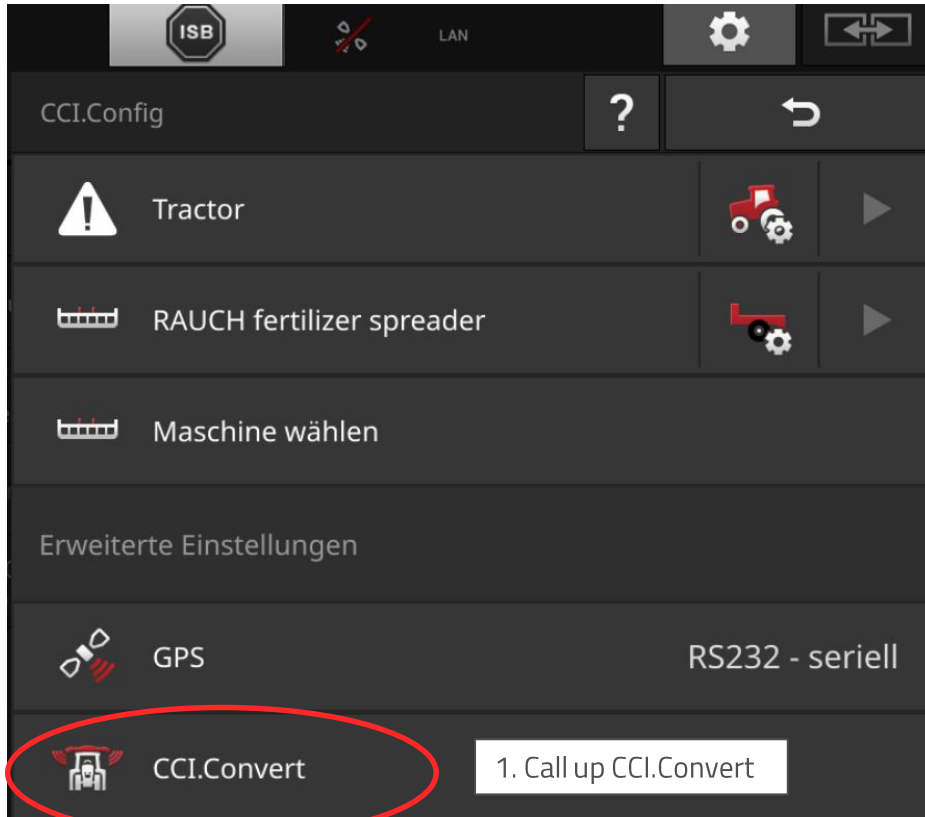

Terminals – ISOBUS CCI 1200

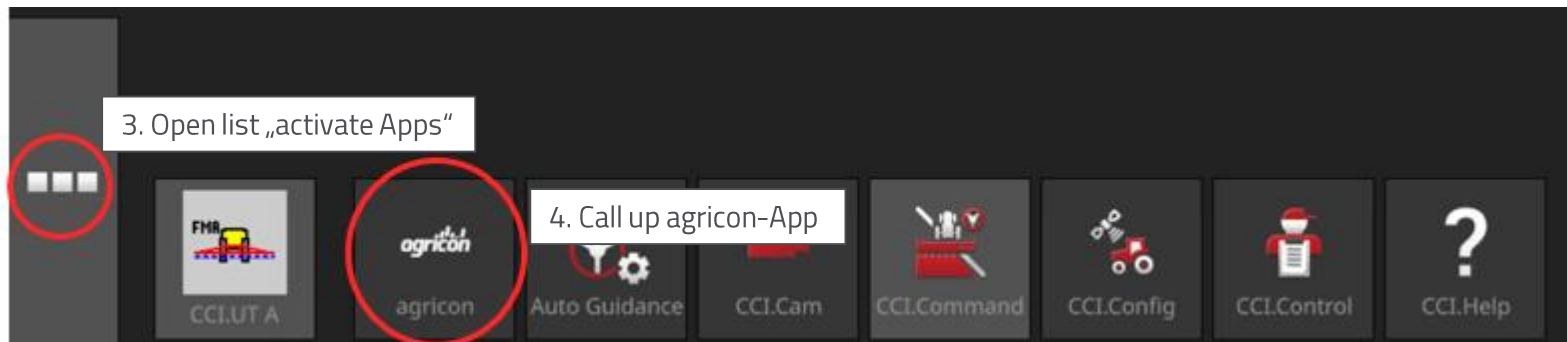
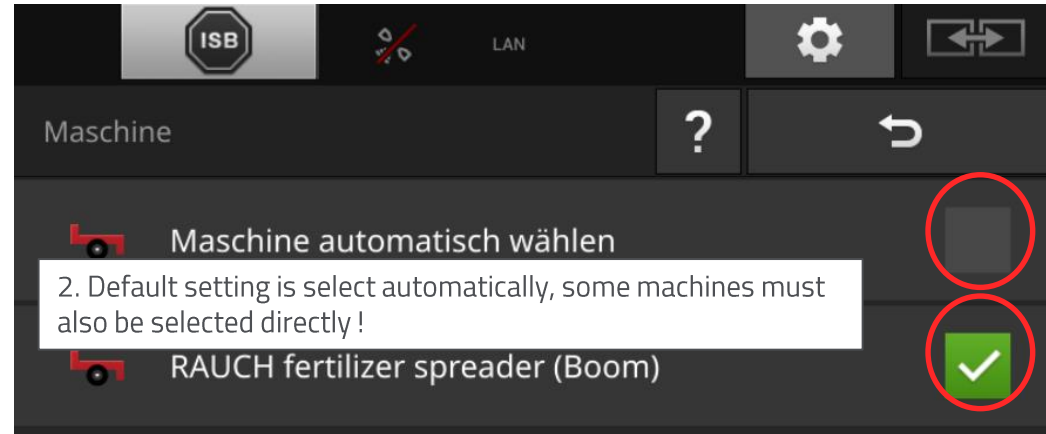
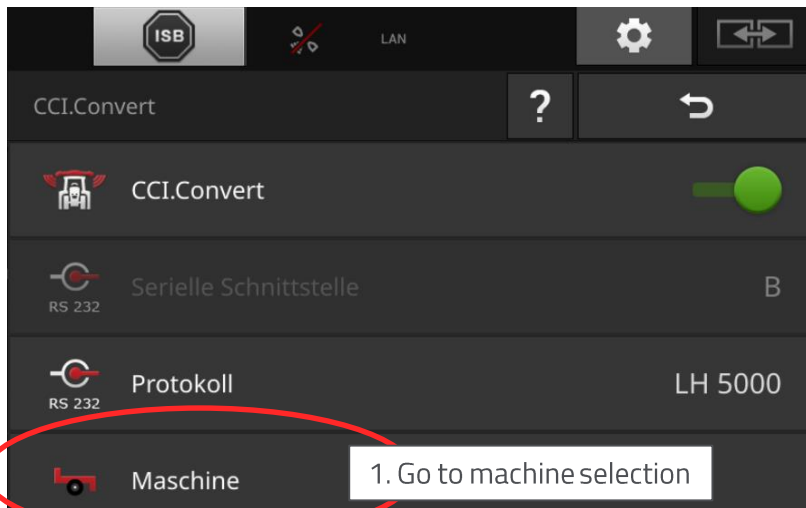

Terminals – ISOBUS CCI 1200

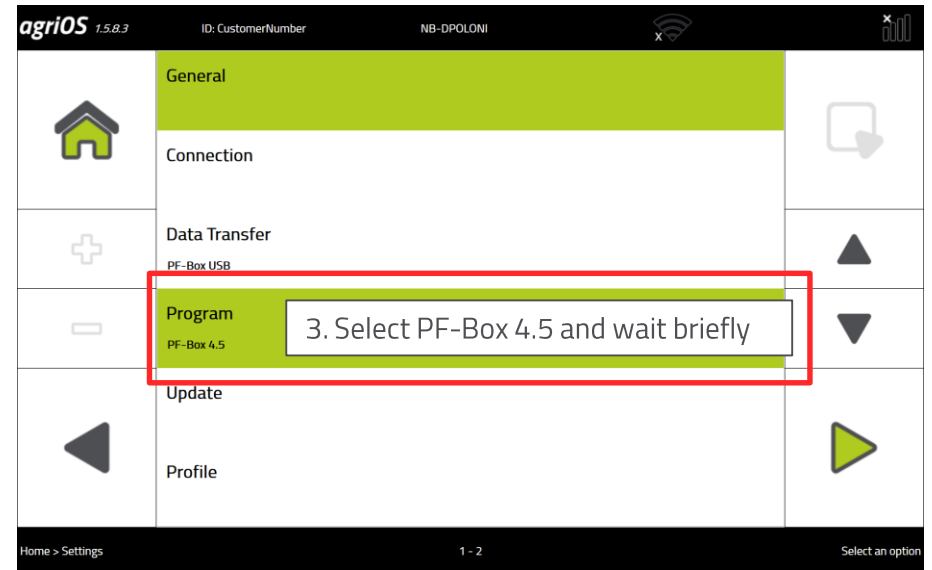
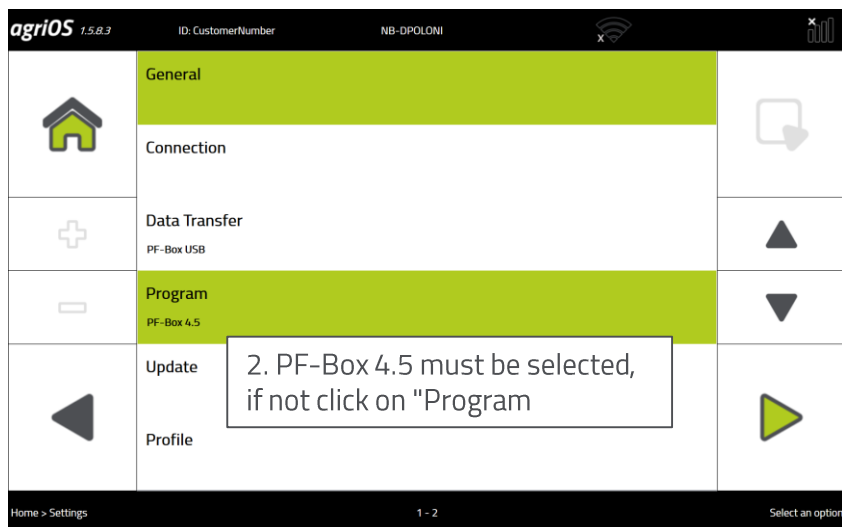
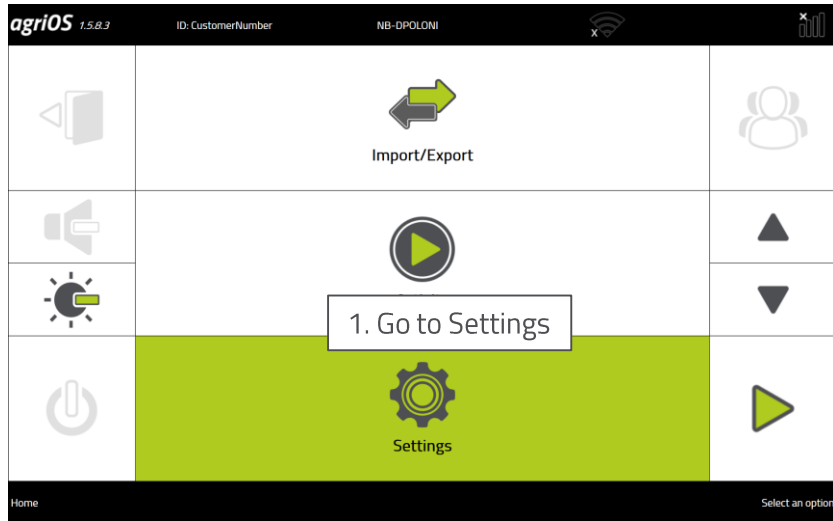

Terminals – ISOBUS CCI 1200

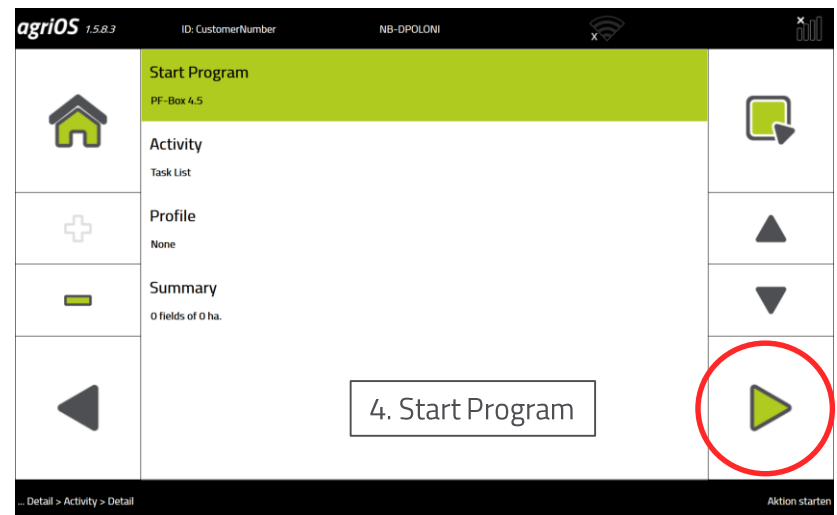
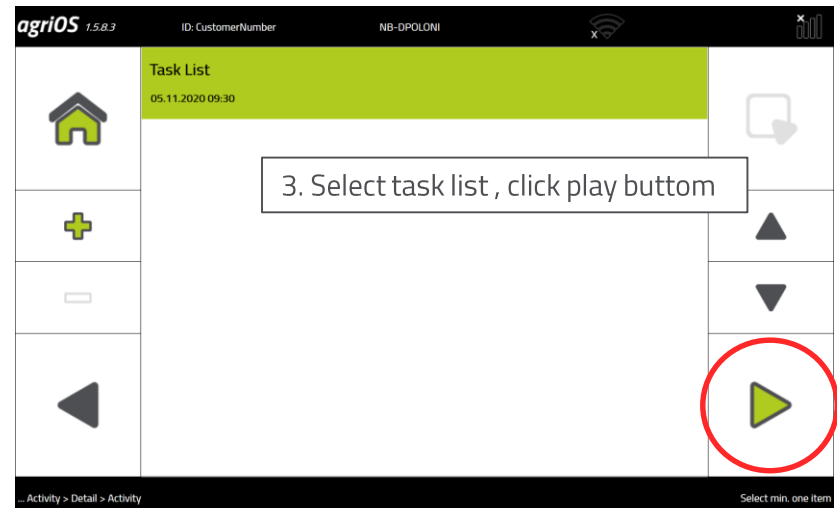

Terminals – ISOBUS CCI 1200



N-application

1. Regardless of which module is started, go to the settings

35

depart

Selectionner modules

1 / 1

implement

3. Go to implement

Selectionner

reglages

1 / 1

Selectionner modules

2. Go to Select Module

Selectionner

implement

reglages / Selection modules

2 / 3

LH 5000

4. Select LH 5000

Selectionner

Terminals – ISOBUS CCI 1200



N-application

1. Regardless of which module is started, go to the settings

35

depart

Configuration modules

reglages 1 / 1

LH 5000

3. Call LH 5000

reglages 1 / 1

Configuration modules

2. Go to configure Modules

LH 5000

reglages / Configuration modules 1 / 1

port serie

4. Go to serial interface and then select, to which COM port the cable to the CCI terminal is connected, COM 1 or COM 2

5. Go back to main menu and start PF-Box

Terminals – ISOBUS CCI 1200



The screenshot displays the Agricon ISOBUS CCI 1200 terminal interface. At the top left, the time is 15:00 and the Agricon logo is visible. The top right shows 'Screenshot gespeichert' and '1/1'. The main interface is divided into several sections:

- Top Left:** A menu icon and 'CCI.Config'.
- Middle Left:** A speedometer showing 0.0 km/h and a gear selection panel with gears 0, 5, 15, and 50.
- Middle Right:** A central display for the RAUCH fertilizer spreader, showing '580 kg/ha' (circled in red), 'KAS', '24 m, S2', and '900 RPM 900'. Below it, 'Trade fair mode active' is displayed.
- Bottom Left:** A 'Zielwertdüngung' (Target Value Fertilization) panel with a 'YARA' logo and a large '150' value (circled in red). It includes a 'Stopp' button and a 'Kamere' label.
- Bottom Center:** A 'CCI.Help' button with a question mark icon.
- Right Side:** A vertical column of control buttons including 'START STOP', 'C/100%', and various spreader adjustment icons.

A white text box in the center of the screen reads: 'The data are now transferred'.

Terminals – ISOBUS CCI 1200



14:49 agricon ISB USB-Stick angeschlossen 1/1

YARA Zielwertdüngung

100% Nach Sensor kg N/ha Konstant

67 +/-

Auftrag 1 Schlag 1 SN: 110

Stopp Karten

112 kg/ha KAS 24 m, S2

6,0 0 0 6,0

900 RPM 900

Trade fair mode active

0,5 ha Trip 0 kg Trip 00 : 00 Leerlaufz.

CCl.Help

0.0 km/h

Place the apps accordingly, so you have always in view.